



**Forest Dene Court, Cedar Road, Sutton, Surrey, SM2 5LP**  
**£110,000**

**A ONE BEDROOM GROUND FLOOR RETIREMENT APARTMENT. Built by McCarthy & Stone (Developments) Ltd with 97 properties over 4 floors, each served by lift. The Development Manager can be contacted from various points within each property in the case of an emergency, alternatively there is a 24 hour emergency call system. The property comprises an entrance hall, lounge, kitchen, bedroom and bathroom. It is a condition of purchase that single residents be over the age of 60 years, or in the event of a couple, one must be over the age of 60 years and the other over 55 years.**





**\*Ground Floor \*Residents Lounge  
\*Communal Laundry \*Car park & buggy  
storage, Guest suite**

---

### **Entrance Hall**

Storage cupboard, doors leading to:

**Reception Room - 17' 5" x 10' 6" (5.30m x 3.20m)**

Door leading to outside area, open archways leading to bedroom

**Bedroom - 14' 0" x 8' 9" (4.26m x 2.66m)**

Wardrobe, storage cupboard, door leading to outside space. Archways leading through to reception room

**Kitchen - 7' 3" x 5' 4" (2.21m x 1.62m)**

Opening from Reception

**Bathroom - 6' 9" x 5' 5" (2.06m x 1.65m)**

Storage cupboard



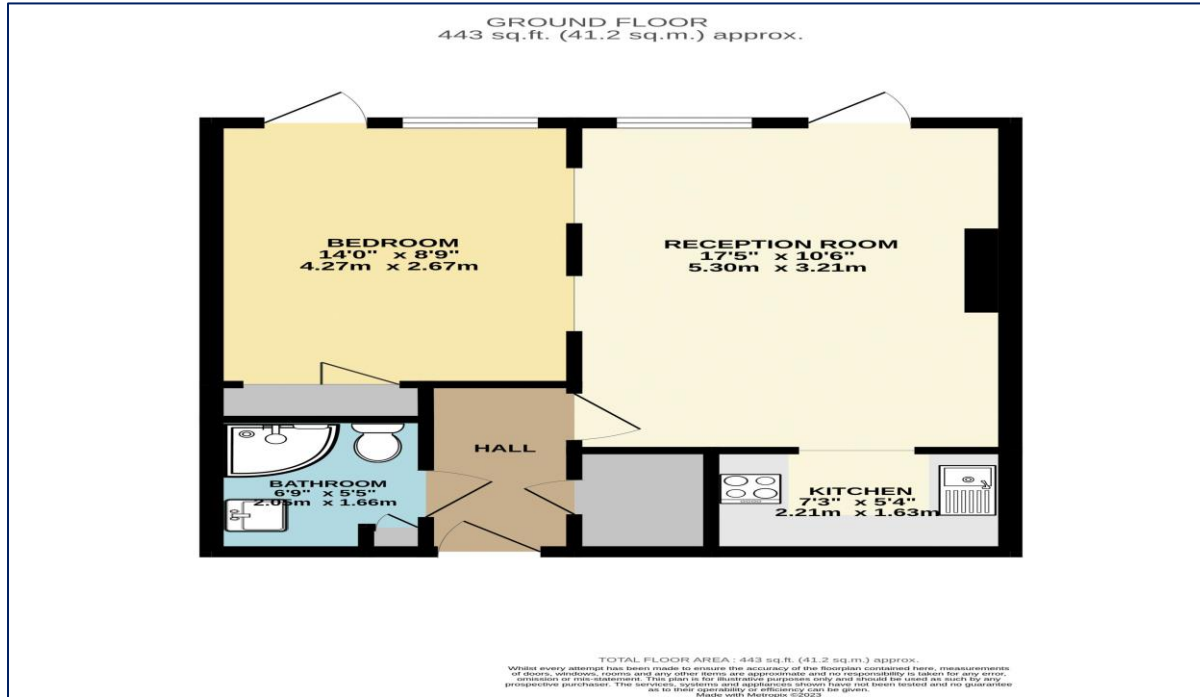

**Council Tax - C**  
**Local Authority: London Borough of Sutton**  
**Tenure - Leasehold**



**95 Banstead Road**  
**Carshalton**  
**Surrey**  
**SM5 3NP**



**020 8642 5468**



**admin@cromwellscarshalton.com**



[www.cromwellsestateagents.uk](http://www.cromwellsestateagents.uk)

| Score | Energy rating | Current | Potential |
|-------|---------------|---------|-----------|
| 92+   | A             |         |           |
| 81-91 | B             |         | 83 B      |
| 69-80 | C             | 80 C    |           |
| 55-68 | D             |         |           |
| 39-54 | E             |         |           |
| 21-38 | F             |         |           |
| 1-20  | G             |         |           |



Disclaimer

These particulars are not an offer or contract, nor part of one. You should not rely on statements made by Cromwells in the particulars or by word of mouth or in writing ("information") as being factually accurate about the property, its condition or value. Neither Cromwells nor any joint agent has authority to make representations about the property, and accordingly any information given is entirely without responsibility on the part of the agents, seller(s) or lessor(s). Photographs show only certain parts of the property as they appeared at the time they were taken. Areas, measurements and distances are given as an approximate only. Any reference to alterations to or use of, any part of the property does not mean that any necessary planning, building regulations or other consents have been obtained